



**PUBLIC PATH EXTINGUISHMENT AND
DEFINITIVE MAP AND STATEMENT MODIFICATION ORDER**

**HIGHWAYS ACT 1980
WILDLIFE AND COUNTRYSIDE ACT 1981**

**THE SHROPSHIRE COUNCIL PARISH OF HIGHLEY, FOOTPATH 37 (PART)
PUBLIC PATH EXTINGUISHMENT ORDER 2026.**

This order is made by The Shropshire Council ("the Council") under section 118 of the Highways Act 1980 ("the 1980 Act") because it appears to the Council that the path or way described in paragraph 1 below is not needed for public use.

This Order is also made under section 53A (2) of the Wildlife and Countryside Act 1981 ("the 1981 Act") because it appears to the authority that the Shropshire definitive map and statement require modification in consequence of the occurrence of the event specified in section 53 (3)(a)(i) of the 1981 Act, namely, the stopping up (as authorised by this Order) of a highway hitherto shown or required to be shown in the definitive map and statement.

BY THIS ORDER:

1. The public right of way over the land situated in the parish of Highley shown by a continuous bold line on the map attached to this Order and described in Part 1 of the Schedule to this Order shall be extinguished on the date of confirmation of this Order and thereupon the Shropshire definitive map shall be modified by deleting from it that public right of way.
2. Notwithstanding paragraph 1 of this Order statutory undertakers shall have the following rights over the land referred to in paragraph 1 above, namely:
Where immediately before the date on which the footpath is extinguished there is apparatus under, in, on, over, along or across it belonging to statutory undertakers for the purpose of carrying on their undertaking, the undertakers

shall continue to have the same right in respect of the apparatus as they then had.

SCHEDULE

PART 1

Description of Public Right of Way Extinguished

Extinguish the full width of that part of the Footpath 37 from Point **A** on the Order map at grid reference SO 7380 8358 running along a fenced in alleyway, through a pedestrian gate and along the field edge to Point **B** on the Order map at grid reference SO 7392 8341. A total distance of approximately 240 metres in length.

Executed as a deed by affixing the
Common Seal of Shropshire Council

In the presence of:

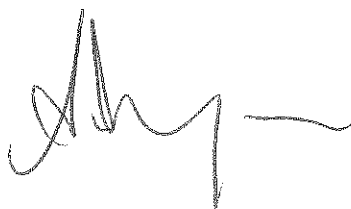

Analise Broomhall
Legal Team Leader - Economy and Projects

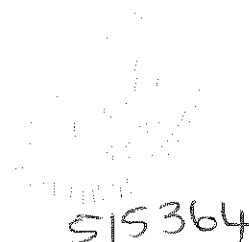

515364

373800

373900

283600

283600

283500

283500

283400

283400

373800

373900

515364

sh

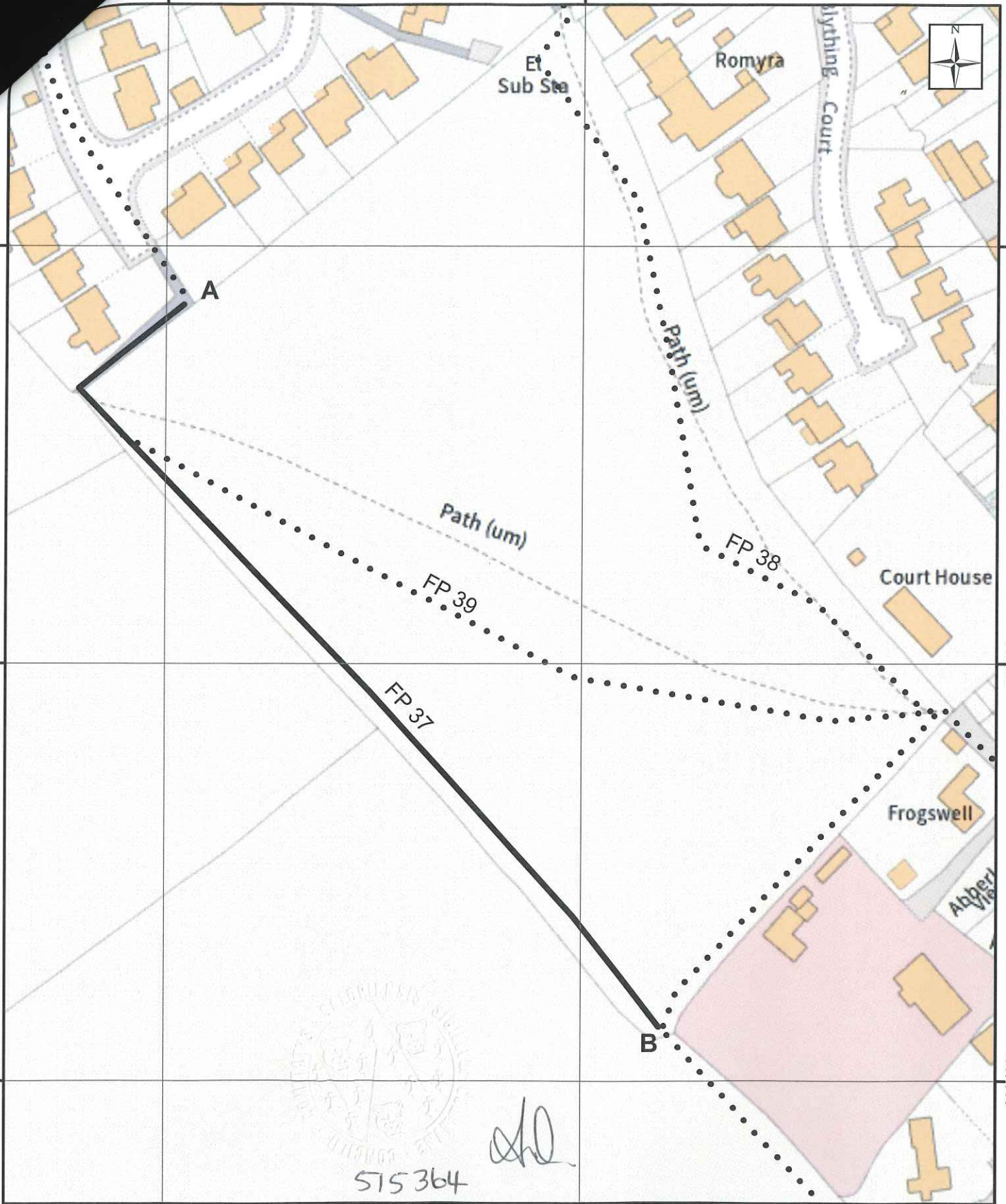

The Shirehall, Abbey Foregate
Shrewsbury, Shropshire, SY2 6ND

Key

Route to be extinguished
Existing to remain

Scale: 1:1,250



© Crown copyright (2024)
Ordnance Survey AC0000808715
You are not permitted to copy, sub-licence, distribute
or sell any of this data to third parties in any form.

PUBLIC PATH EXTINGUISHMENT AND
DEFINITIVE MAP AND STATEMENT
MODIFICATION ORDER
HIGHWAYS ACT 1980 (SECTION 118)
WILDLIFE AND COUNTRYSIDE ACT 1981

THE SHROPSHIRE COUNCIL
(FP 37 (PART) PARISH OF HIGHLEY)
PUBLIC PATH EXTINGUISHMENT
ORDER 2026.

RIGHTS OF WAY TEAM
OUTDOOR PARTNERSHIPS
SHROPSHIRE COUNCIL
THE GUILDHALL
FRANKWELL QUAY
SHREWSBURY
SY3 8HQ

This information is supplied in connection with an order made by Shropshire Council under the Highways Act 1980 and is not to be used for any other purpose. Shropshire Council asserts its right to the copyright of this order. It may not be reproduced or transmitted in any other form or by any means or stored in any retrieval system of any nature without prior written permission except for the purposes of this consultation.